

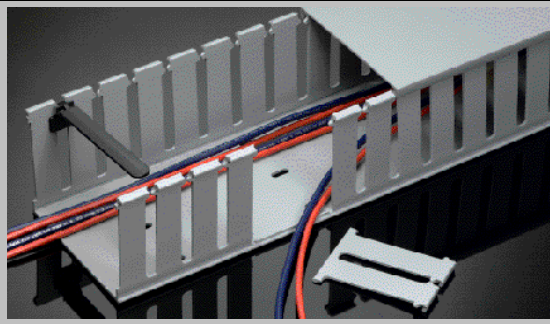

NETWORK SYSTEMS GROUP

# PANDUCT® Type NE & NS Wiring Duct

Application / Specification Guide



## Type NE Slotted Wall Duct

Noryl® Halogen Free Material

30 sizes: From 0.5" x 0.5" up to 4" x 5"

Ideal for use in:

- Extreme Temperature Environments; -40°C (-40°F) to 95°C (203°F)
- Installations requiring Halogen free products
- Applications requiring multiple wire breakouts

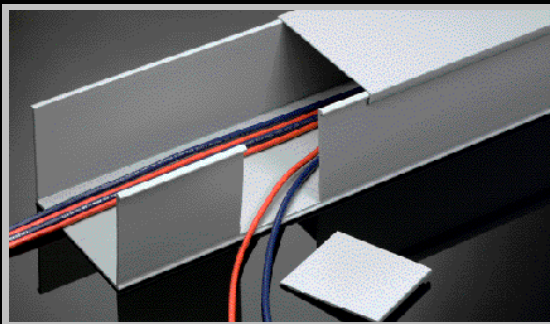

## Type NS Solid Wall Duct

Noryl® Halogen Free Material

30 sizes: From 0.5" x 0.5" up to 4" x 5"

Ideal for use in:

- Extreme Temperature Environments; -40°C (-40°F) to 95°C (203°F)
- Installations requiring Halogen free products
- Applications requiring longer runs with minimal breakouts

## GENERAL PURPOSE USE:

### Control Panels

- Routes and protects wires inside the panel
- Duct cover conceals wiring to improve appearance of the control panel
- Changes may be made quickly by removing the duct cover, which allows full access to wires inside the duct

### Communication Closets

- Organizes and protects wires entering the closet as well as those terminated to patch panels and patchdown blocks
- Improves appearance of the communication closet by keeping wires out of sight
- Eliminates need to strap and bundle wires
- Changes may be made quickly by removing the duct cover, which allows full access to wires inside the duct

# HALOGEN FREE



**UL Recognized**  
File No. E147128



**CSA Certified**  
File No. 16446

**Noryl® Halogen Free Material**

**Available in Light Gray (LG) and White (WH)**

**UL Flammability Rating: 94V-1**

**Temperature Rating:** rated for continuous use temperatures from -40°C (-40°) to 95°C (95°)

# PANDUCT® Type NE & NS Wiring Duct

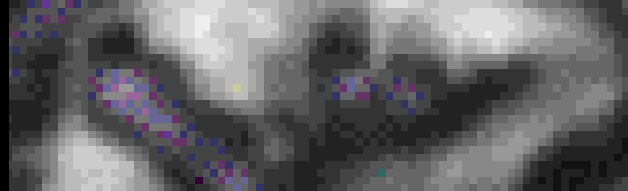

## Type NE and NS—Wiring Duct Standard Colors:

<b>LG</b>	<b>WH</b>
Light Gray	White

Colors shown are approximate.

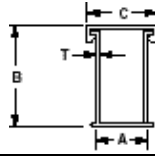

NE DUCT PART NUMBERS	NS DUCT PART NUMBERS	Actual Duct Size		COVER PART NUMBER	Duct Std. Ctn. Qty.	Cover Std. Ctn. Qty.	Std. Length
		WxH IN.	WxH (mm)				
NE.5X.5LG6 NE.5X.62LG6 NE.5X1LG6 NE.5X1.25LG6 NE.5X1.75LG6	NS.5X.5LG6NM NS.5X.62LG6NM NS.5X1LG6NM NS.5X1.25LG6NM NS.5X1.75LG6NM	0.63 x 0.56 0.63 x 0.68 0.63 x 1.06 0.63 x 1.31 0.63 x 1.81	(16.0) x (14.2) (16.0) x (17.3) (16.0) x (26.9) (16.0) x (33.3) (16.0) x (46.0)	NC.5LG6	120 ft. 120 ft. 120 ft. 120 ft. 120 ft.	120 ft. 120 ft. 120 ft. 120 ft. 120 ft.	6 ft.
NE1X1LG6 NE1X1.5LG6 NE1X2LG6 NE1X3LG6 NE1X4LG6	NS1X1LG6NM NS1X1.5LG6NM NS1X2LG6NM NS1X3LG6NM NS1X4LG6NM	1.14 x 1.12 1.14 x 1.62 1.14 x 2.12 1.14 x 3.12 1.14 x 4.12	(29.0) x (28.4) (29.0) x (41.1) (29.0) x (53.8) (29.0) x (79.2) (29.0) x (104.6)	NC.75LG6	120 ft. 120 ft. 120 ft. 120 ft. 120 ft.	120 ft. 120 ft. 120 ft. 120 ft. 120 ft.	6 ft.
NE1.5X1LG6 NE1.5X1.5LG6 NE1.5X2LG6 NE1.5X3LG6 NE1.5X4LG6	NS1.5X1LG6NM NS1.5X1.5LG6NM NS1.5X2LG6NM NS1.5X3LG6NM NS1.5X4LG6NM	1.64 x 1.12 1.64 x 1.62 1.64 x 2.12 1.64 x 3.12 1.64 x 4.12	(41.7) x (28.4) (41.7) x (41.1) (41.7) x (53.8) (41.7) x (79.2) (41.7) x (104.6)	NC1LG6	120 ft. 120 ft. 120 ft. 120 ft. 120 ft.	120 ft. 120 ft. 120 ft. 120 ft. 120 ft.	6 ft.
NE2X1LG6 NE2X1.5LG6 NE2X2LG6 NE2X3LG6 NE2X4LG6	NS2X1LG6NM NS2X1.5LG6NM NS2X2LG6NM NS2X3LG6NM NS2X4LG6NM	2.14 x 1.12 2.14 x 1.62 2.14 x 2.12 2.14 x 3.12 2.14 x 4.12	(54.4) x (28.4) (54.4) x (41.1) (54.4) x (53.8) (54.4) x (79.2) (54.4) x (104.6)	NC1.5LG6	120 ft. 120 ft. 120 ft. 60 ft. 60 ft.	120 ft. 120 ft. 120 ft. 120 ft. 120 ft.	6 ft.
NE2.5X3LG6	NS2.5X3LG6NM	2.64 x 3.12	(67.1) x (79.2)		60 ft.	120 ft.	6 ft.
NE3X1LG6 NE3X2LG6 NE3X3LG6 NE3X4LG6 NE3X5LG6	NS3X1LG6NM NS3X2LG6NM NS3X3LG6NM NS3X4LG6NM NS3X5LG6NM	3.14 x 1.12 3.14 x 2.12 3.14 x 3.12 3.14 x 4.12 3.14 x 5.12	(79.8) x (28.4) (79.8) x (53.8) (79.8) x (79.2) (79.8) x (104.6) (79.8) x (130.0)	NC2.5LG6	120 ft. 120 ft. 60 ft. 60 ft. 60 ft.	120 ft. 120 ft. 120 ft. 120 ft. 120 ft.	6ft.
NE4X2LG6 NE4X3LG6 NE4X4LG6 NE4X5LG6	NS4X2LG6NM NS4X3LG6NM NS4X4LG6NM NS4X5LG6NM	4.14 x 2.12 4.14 x 3.12 4.14 x 4.12 4.14 x 5.12	(105.2) x (53.8) (105.2) x (79.2) (105.2) x (104.6) (105.2) x (130.0)	NC3LG6	60 ft. 60 ft. 60 ft. 60 ft.	120 ft. 120 ft. 120 ft. 120 ft.	6 ft.

\* See page 4 for actual dimensions.  
† Adhesive tape is not CSA Certified

### Ordering Information:

- Order number of feet required in multiples of 6 ft or standard carton quantities.
- To order slotted wall duct without mounting holes, add NM to the Part Number. Solid wall duct is supplied without mounting holes as a standard.
- To order with pressure-sensitive adhesive mounting tape applied, add -A to Part Number.
- Part Number shown for Light Gray LG and White WH. To order other colors substitute colors listed in chart above.
- Note: Order Duct And Cover Separately

### Part Number Nomenclature —

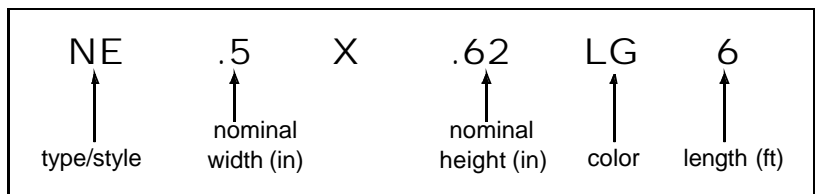

## Type NE—Slotted Wiring Duct

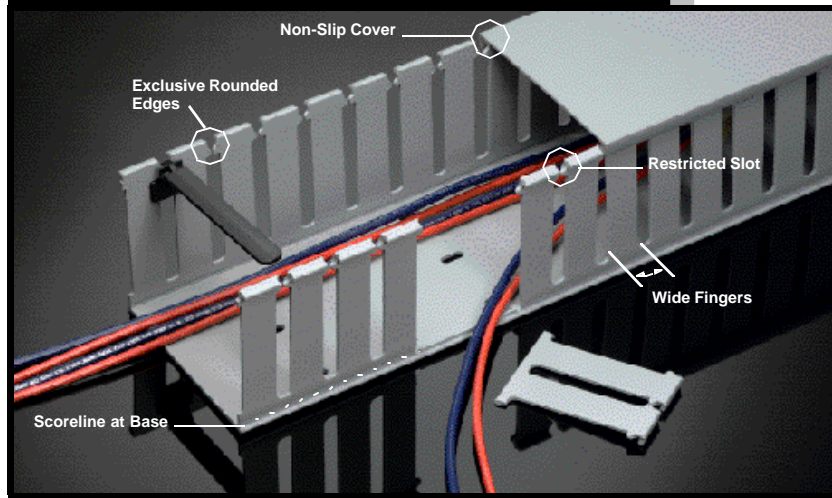

### Halogen Free Material

- Made of chlorine-free material which meets Halogen free requirements

### Increased Temperature Resistance

- Rated for temperatures from -40°C (-40°F) up to 95° C (203°F)

### Restricted Slot Design

- Retains wire in slot
- Speeds installation
- Simply deflect finger for fast, easy wire installation or removal

### Exclusive Rounded Edges Along Entire Slot

- Protect wires and hands from abrasion

### Non-Slip Cover Design

- Incorporates integral high friction lining to inhibit cover movement

### Easy Cover Removal

- Changes to wiring can be made quickly and easily

### Bar Coded Part Number Label with QC Number

- Allows for automated inventory control systems
- Quick identification of loose piece duct
- Complete quality traceability

### Optional Pressure-Sensitive Adhesive Mounting Tape

### Scoreline Along Base

- For easy removal of fingers with use of DNT-100

### Halogen Free Material

- Made of chlorine-free material which meets Halogen free requirements

### Increased Temperature Resistance

- Rated for temperatures from -40°C (-40°F) up to 95°C (203°F)

### Solid Walls

- Provide maximum wire protection

### Non-Slip Cover Design

- Incorporates integral high friction lining to inhibit cover movement

### Easy Cover Installation and Removal

- Changes to wiring can be made quickly and easily

### Bar Coded Part Number Label with QC Number

- Allows for automated inventory control systems
- Quick identification of loose piece duct
- Complete quality traceability

### Optional Pressure-Sensitive Adhesive Mounting Tape

### Scoreline Along Base

- For easy removal of solid wall section when cut to base

## Type NS—Solid Wiring Duct

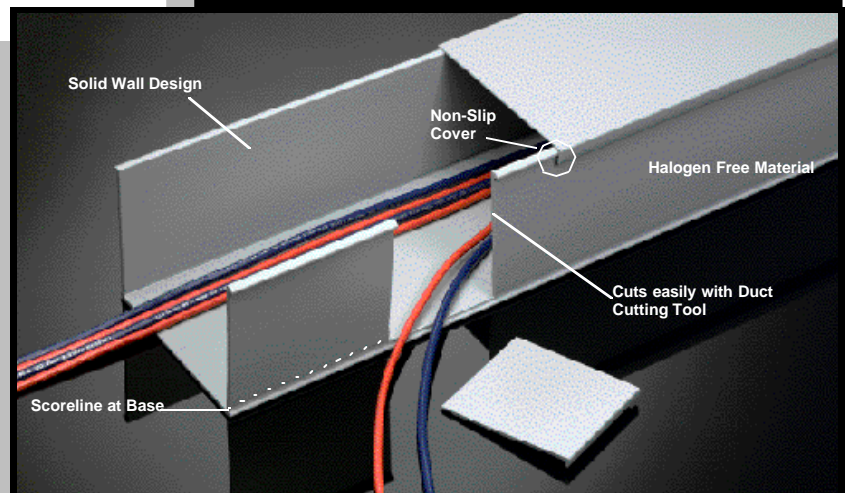

# Type NE and NS Duct Cover Dimensions:

NOMINAL DUCT SIZE (W x H)	DIMENSIONS-Inches (mm)							
	A	B	D	E	F	K	T	Cover
.5 x .5 (12.7) (12.7)	0.63 (16.0)	0.56 (14.2)	0.38 (9.7)	0.37 (9.4)	0.80 (20.3)	"ON CENTERLINE"	0.05 (1.3)	0.69 (17.5)
.5 x .62 (12.7) (15.7)	0.63 (16.0)	0.68 (17.3)	0.38 (9.7)	0.37 (9.4)	0.80 (20.3)		0.05 (1.3)	0.69 (17.5)
5 x 1 (12.7) (25.4)	0.63 (16.0)	1.06 (26.9)	0.75 (19.1)	0.31 (7.9)	0.80 (20.3)		0.06 (1.5)	0.69 (17.5)
.5 x 1.25 (12.7) (31.8)	0.63 (16.0)	1.31 (33.3)	1.00 (25.4)	0.31 (7.9)	0.80 (20.3)		0.06 (1.5)	0.69 (17.5)
.5 x 1.75 (12.7) (44.45)	0.63 (16.0)	1.81 (46.0)	1.44 (36.6)	0.31 (7.9)	0.80 (20.3)		0.07 (1.8)	0.69 (17.5)
1 x 1 (19.1) (25.4)	1.14 (29.0)	1.12 (28.4)	0.75 (19.1)	0.31 (7.9)	0.80 (20.3)		0.06 (1.5)	1.25 (31.8)
1 x 1.5 (25.4) (38.1)	1.14 (29.0)	1.62 (41.1)	1.20 (30.5)	0.31 (7.9)	0.80 (20.3)		0.07 (1.8)	1.25 (31.8)
1 x 2 (25.4) (38.1)	1.14 (29.0)	2.12 (53.8)	1.63 (41.4)	0.31 (7.9)	0.80 (20.3)		0.08 (2.0)	1.25 (31.8)
1 x 3 (25.4) (76.2)	1.14 (29.0)	3.12 (79.2)	2.63 (66.8)	0.31 (7.9)	1.00 (25.4)		0.10 (2.4)	1.25 (31.8)
1 x 4 (25.4) (101.5)	1.14 (29.0)	4.12 (104.6)	3.63 (92.2)	0.31 (7.9)	1.00 (25.4)		0.11 (2.7)	1.25 (31.8)
1.5 x 1 (38.1) (25.4)	1.64 (41.7)	1.12 (28.4)	0.75 (19.1)	0.31 (7.9)	0.80 (20.3)		0.06 (1.5)	1.75 (44.5)
1.5 x 1.5 (38.1) (38.1)	1.64 (41.7)	1.62 (41.1)	1.20 (30.5)	0.31 (7.9)	0.80 (20.3)		0.07 (1.8)	1.75 (44.5)
1.5 x 2 (38.1) (50.8)	1.64 (41.7)	2.12 (53.8)	1.63 (41.4)	0.31 (7.9)	0.80 (20.3)		0.08 (2.0)	1.75 (44.5)
1.5 x 3 (38.1) (76.2)	1.64 (41.7)	3.12 (79.2)	2.63 (66.8)	0.31 (7.9)	1.00 (25.4)		0.10 (2.4)	1.75 (44.5)
1.5 x 4 (38.1) (101.6)	1.64 (41.7)	4.12 (104.6)	3.63 (92.2)	0.31 (7.9)	1.00 (25.4)		0.11 (2.7)	1.75 (44.5)
2 x 1 (50.8) (25.4)	2.14 (54.4)	1.12 (28.4)	0.75 (19.1)	0.31 (7.9)	0.80 (20.3)		0.50 (12.7)	2.25 (57.2)
2x1.5 (50.8) (38.1)	2.14 (54.4)	1.62 (41.1)	1.20 (30.5)	0.31 (7.9)	0.80 (20.3)		0.50 (12.7)	2.25 (57.2)
2x2 (50.8) (50.8)	2.14 (54.4)	2.12 (53.8)	1.63 (41.4)	0.31 (7.9)	0.80 (20.3)		0.50 (12.7)	2.25 (57.2)
2 x 3 (50.8) (76.2)	2.14 (54.4)	3.12 (79.2)	2.63 (66.8)	0.31 (7.9)	1.00 (25.4)		0.50 (12.7)	2.25 (57.2)
2x4 (50.8) (101.6)	2.14 (54.4)	4.12 (104.6)	3.63 (92.2)	0.31 (7.9)	1.00 (25.4)		0.50 (12.7)	2.25 (57.2)
2.5 x 3 (63.5) (76.2)	2.64 (67.1)	3.12 (79.2)	2.63 (66.8)	0.31 (7.9)	1.00 (25.4)	0.75 (19.1)	2.75 (69.9)	
3 x 1 (76.2) (25.4)	3.14 (79.8)	1.12 (28.4)	.75 (19.1)	.31 (7.9)	0.80 (20.3)	1.00 (25.4)	3.25 (82.6)	
3x2 (76.2) (50.8)	3.14 (79.8)	2.12 (53.8)	1.63 (41.4)	0.31 (7.9)	0.80 (20.3)	1.00 (25.4)	3.25 (82.6)	
3x3 (76.2) (76.2)	3.14 (79.8)	3.12 (79.2)	2.63 (66.8)	0.31 (7.9)	1.00 (25.4)	1.00 (25.4)	3.25 (82.6)	
3x4 (76.2) (101.6)	3.14 (79.8)	4.12 (104.6)	3.63 (92.2)	0.31 (7.9)	1.00 (25.4)	1.00 (25.4)	3.25 (82.6)	
3x5 (76.2) (127.0)	3.14 (79.8)	5.12 (130.0)	4.63 (117.6)	0.37 (9.4)	1.34 (34.0)	1.00 (25.4)	3.25 (82.6)	
4x2 (101.6) (50.8)	4.14 (105.2)	2.12 (53.8)	1.63 (41.4)	0.31 (7.9)	0.80 (20.3)	1.50 (38.1)	4.25 (108.0)	
4x3 (101.6) (76.2)	4.14 (105.2)	3.12 (79.2)	2.63 (66.8)	0.31 (7.9)	1.00 (25.4)	1.50 (38.1)	4.25 (108.0)	
4x4 (101.6) (101.6)	4.14 (105.2)	4.12 (104.6)	3.63 (92.2)	0.31 (7.9)	1.00 (25.4)	1.50 (38.1)	4.25 (108.0)	
4x5 (101.6) (127.0)	4.14 (105.2)	5.12 (130.0)	4.63 (117.6)	0.37 (9.4)	1.50 (38.1)	1.50 (38.1)	4.25 (108.0)	

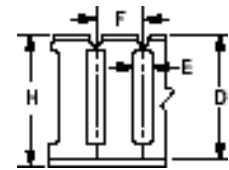
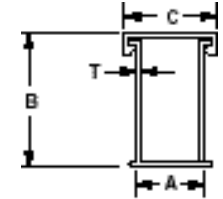

Type NE,  
(Snap-in-Slot)

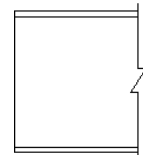

Type NS,  
(Solid Wall)

Note: "A" dimension is measured at base  
 Note: "K" dimension shown in mounting hole dimensions below

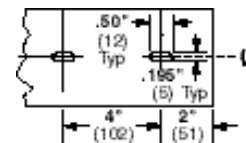

For 2.0", 2.5", 3.0", 4.0" and 6.0" width duct:

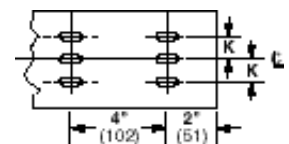

NOTE: For Types E, NE, PE & D Duct, if no mounting holes are required, add NM to the Part Number

NOTE 2: For Types S, NS & PS Duct, no mounting holes are provided; if required delete NM from the Part Number



# Cable Fill Capacities

NOMINAL DUCT SIZE (W X H)	AREA in <sup>2</sup>	ELECTRICAL												CAT 5 CABLES				
		8 AWG		10 AWG		12 AWG		14 AWG		16 AWG		18 AWG		22 AWG		24 AWG		
		.216	.153	.122	.158	.105	.139	.165	.096	.125	.084	.113	.065	.217	.250	.422	UT P/CM CAT 5	ST P/CM CAT 5
		THHN	THHN	THHN	MTW	THHN	MTW	MTW	TFN	MTW	TFN	MTW	MTW					
.5 x .5	0.250	3	5	8	5	11	6	5	14	8	18	10	30	3	2	1		
.5 x .62	0.310	3	7	10	6	14	8	6	17	10	22	12	37	3	2	1		
.5 x 1	0.500	5	11	17	10	23	13	9	27	16	35	20	59	5	4	1		
.5 x 1.25	0.625	7	13	21	13	28	16	11	34	20	44	24	74	7	5	2		
.5 x 1.75	0.875	9	19	29	18	40	23	16	47	28	62	34	104	9	7	2		
1 x 1	1.000	11	21	34	20	45	26	18	54	32	71	39	118	11	8	3		
1 x 1.5	1.500	16	32	50	30	68	39	28	81	48	106	59	178	16	12	4		
1 x 2	2.000	21	43	67	40	91	52	37	109	64	142	78	237	21	16	6		
1 x 3	3.000	32	64	101	60	136	78	55	163	96	213	117	355	32	24	8		
1 x 4	4.000	43	85	134	80	181	104	73	217	128	283	157	473	42	32	11		
1.5 x 1	1.500	16	32	50	30	68	39	28	81	48	106	59	178	16	12	4		
1.5 x 1.5	2.250	24	48	76	45	102	58	41	122	72	159	88	266	24	18	6		
1.5 x 2	3.000	32	64	101	60	136	78	55	163	96	213	117	355	32	24	8		
1.5 x 3	4.500	48	96	151	90	204	116	83	244	144	319	176	533	48	36	13		
1.5 x 4	6.000	64	128	202	120	272	155	110	326	192	425	235	710	64	48	17		
2 x 1	2.000	21	43	67	40	91	52	37	109	64	142	78	237	21	16	6		
2x1.5	3.000	32	64	101	60	136	78	55	163	96	213	117	355	32	24	8		
2x2	4.000	43	85	134	80	181	104	73	217	128	283	157	473	42	32	11		
2 x 3	6.000	64	128	202	120	272	155	110	326	192	425	235	710	64	48	17		
2x4	8.000	86	171	269	160	363	207	147	434	256	567	313	947	85	64	22		
2.5 x 3	7.500	80	160	252	150	340	194	138	407	240	531	294	888	80	60	21		
3 x 1	3.000	32	64	101	60	136	78	55	163	96	213	117	355	32	24	8		
3x2	6.000	64	128	202	120	272	155	110	326	192	425	235	710	64	48	17		
3x3	9.000	96	192	302	180	408	233	165	488	288	638	352	106	96	72	25		
3x4	12.000	129	256	403	240	544	311	220	651	384	850	470	142	127	96	34		
3x5	15.000	161	320	504	300	680	388	275	814	480	106	587	177	159	120	42		
4x2	8.000	86	171	269	160	363	207	147	434	256	567	313	947	85	64	22		
4x3	12.000	129	256	403	240	544	311	220	651	384	850	470	142	127	96	34		
4x4	16.000	171	342	537	320	726	414	294	868	512	113	627	189	170	128	45		
4x5	20.000	214	427	672	401	907	518	367	108	640	141	783	236	212	160	56		

## Formula used to calculate fill capacity:

$$\text{Number of Wires} = \frac{\text{Duct W x H}}{2.00 \times (\text{Wire O.D.})^2}$$

## Formula to approximate wiring duct size needed:

- Determine the number of wires the duct will need to hold.
- Determine the wire outside diameter (for multiple wires see formula at left).
- Calculate the necessary wire area using the following formula:

$$\text{Wire Area} = \text{Number of Wires} \times [2 \times (\text{Wire O.D.})^2]$$

Example: Wire Area = 59 X [2 X (.107)<sup>2</sup>] = 59 X .023 = 1.357

- Choose a Duct with W X H that is equal to or greater than the result from step 3.

$$\text{Selected Duct Area} \geq \text{Calculated Wire Area}$$

Example: For Duct Size .75 X 1.5 Duct Area=1.125      For Duct Size 1.5 X 1.0 Duct Area=1.500

Not Good 1.125 < 1.357      Good 1.500 > 1.357

In the above example 1 x 1.5 duct or a larger duct size could also be used.

## Wire O.D. for multiple wire types:

$$\text{Wire O.D.} = \frac{\sqrt{\text{Number of Wires} \times \text{Wire O.D.}^2}}{\text{Number of Wires}}$$

Example:

15 wires with .165 O.D. = 15 x .165 = 2.475  
 28 wires with .065 O.D. = 28 x .065 = 1.820  
 16 wires with .125 O.D. = 16 x .125 = 2.000  
 59 total wires = 6.295

6.295 ÷ 59 = Wire O.D. = .107

## Physical Properties

Properties	Test Method	Noryl	Units
<b>GENERAL</b>			
Specific Gravity	ASTM D 792	1.08	g/cc
Heat Deflection Temp. @ 264 psi	ASTM D 648	212	°F
Thermal Expansion	ASTM D 696	3.8	10 in/in/°F
Thermal Conductivity	ASTM C 177	1.1	(BTU-in/hr-ft <sup>2</sup> -F)
Compressive Yield Strength	ASTM D 695	12,000	psi
<b>BURNING CHARACTERISTICS</b>			
Flammability Class	UL 94	V-1	—
Smoke Density	ASTM E 662	N/A	—
Limited Oxygen Index (LOI)	ASTM D 2863	30	—
<b>HARDNESS</b>			
Durometer Hardness	ASTM D 2240	85	°D*
Rockwell Hardness	ASTM D 785	115	°R*
<b>TENSILE</b>			
Strength at Yield	ASTM D 638	6,900	psi
Modulus	ASTM D 638	380,000	psi

Properties	Test Method	Noryl	Units
<b>FLEXURAL</b>			
Strength at Yield	ASTM D 790	11,400	psi
Modulus	ASTM D 790	365,000	psi
<b>IMPACT STRENGTH</b>			
Notched Izod (.125") at:	ASTM D 256		
23°C (73°F)		5.0	ft-lb/in
0°C (32°F)		N/A	ft-lb/in
-18°C (0°F)		N/A	ft-lb/in
Unnotched Modified Izod at	ASTM D 256		
23°C (73°F)		N/A	ft-lb/in
0°C (32°F)		N/A	ft-lb/in
-18°C (0°F)		N/A	ft-lb/in
<b>ELECTRICAL PROPERTIES</b>			
Power Factor	ASTM D 150		
60 Hz @ 30°C (86°F)		N/A	—
1 Mz @ 30°C (86°F)		N/A	—
Dielectric Constant	ASTM D 150		
60 Hz @ 30°C (86°F)		2.65	—
1 Mz @ 30°C (86°F)		N/A	—
Dielectric Strength	ASTM D 149		
Normal		400	volts/mil
Moist		N/A	volts/mil

# PANDUCT® Type NE & NS Wiring Duct

## PANDUCT® Divider Wall

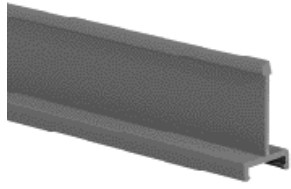

- PVC divider wall snaps onto mounting below

## PANDUCT® Slotted Divider Wall

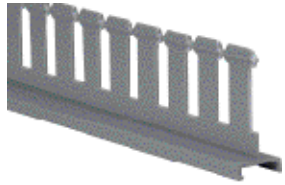

- Slotted PVC divider wall snaps onto mounting base below

## Divider Wall Mounting Base

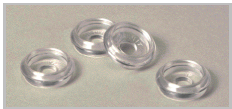

- Mounting Base accepts divider wall above.

NOTE: Recommend use of 4 mounting bases for every 6 feet of divider wall installed.

## Wire Retainer

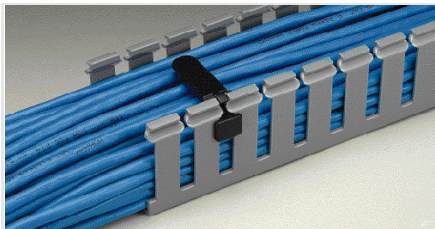

- Made of ABS



Part Number	For Duct Height Inches (mm)	Std. Length	Std. Ctn. Qty.
D1H6	1.00 (25.4)	6 ft.	120 ft.
D1.5H6	1.50 (38.1)		
D2H6	2.00 (50.8)		
D3H6	3.00 (76.2)		
D4H6	4.00 (101.6)		

Part Number	For Duct Height Inches (mm)	Std. Length	Std. Ctn. Qty.
SD2H6	2.00 (50.8)	6 ft.	120 ft.
SD3H6	3.00 (76.2)		
SD4H6	4.00 (101.6)		

ORDERING INFORMATION: Order number of feet required in multiples of 6 ft. or standard carton quantities.

Part Number	Used with Anchors	Std. Pkg. Qty.
DB-C	Panduit NR1 Rivets, or #8 or #10 screws.	100 pcs.

ORDERING INFORMATION: Order in multiples of standard package quantity.

Part Number	For Duct Width Inches (mm)	Std. Pkg. Qty.
WR2-C	2.00 (50.8) Except 2 X 5 duct size	100 pcs.
WR3-C	3.00 (76.2) Except 3 X 5 duct size	100 pcs.
WR4-C	4.00 (101.6) Except 4 X 5 duct size	100 pcs.
WR5-C	2.0 (50.8), 3.0 (76.2), 4.0 (101.6), 6.0 (152.4) For use with 5" height wire duct	100 pcs.

ORDERING INFORMATION: Order number of pieces required multiples of standard package quantity.

## PANDUCT® Duct Cutting Tool

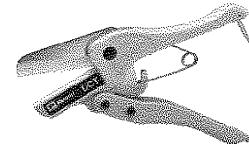

Part No: DCT Std. Pkg. Qty.: 1 pc.

## PANDUCT® Duct Notching Tool

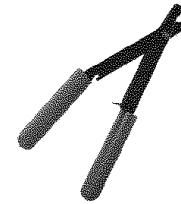

Part No: DNT-100 Std. Pkg. Qty.: 1 pc.

## PANDUCT® Duct Notching Tool & Nylon Rivets



Part No: TNR Std. Pkg.: 1 pc.

Part No: NR1-C Std. Pkg.: 100

Total Thickness of Panel & Duct	Panel Hole Dia. Needed
.158" (4.0)–.187" (4.7)	.187" (4.7)
.188" (4.8)–.218" (5.5)	.193" (4.9)
.219" (5.6)–.250" (6.4)	.203" (5.2)
.251" (6.5) and up	.213" (5.4)

ORDERING INFORMATION: Order number of pieces required in multiples of standard package quantity.

Our products are warranted to be free from defects in material and workmanship at the time of sale but our obligation under this warranty is limited to the replacement of any product proved to be defective within 6 months (for product) or 90 days (for tools) from the date of delivery. Tool warranty is void if Panduit tools are modified, altered or misused in any way. Use of Panduit tooling with any product other than the specified Panduit products for which the tool was designed, constitutes misuse. Before using, user shall determine the suitability of the product for his intended use and user assumes all risk and liability whatsoever in connection therewith.

This warranty is made in lieu of and excludes all other warranties, expressed or implied. THE IMPLIED WARRANTIES OF MERCHANTABILITY AND FITNESS FOR A PARTICULAR USE ARE SPECIFICALLY EXCLUDED. Neither seller nor manufacturer shall be liable for any other injury, loss or damage, whether direct or consequential, arising out of the use of, or the inability to use, the product.

The information contained in this literature is based on our experience to date and is believed to be reliable. It is intended as a guide for use by persons having technical skill at their own discretion and risk. We do not guarantee favorable results or assume any liability in connection with its use. Dimensions contained herein are for reference purposes only. For specific dimensional requirements consult the factory. This publication is not to be taken as a license to operate under, or a recommendation to infringe any existing patents. This supersedes and voids all previous literature, etc.



NETWORK SYSTEMS DIVISION

WORLD HEADQUARTERS  
PANDUIT CORP.

Tinley Park, Illinois, USA  
Phone: 888-506-5400  
708-532-1800, ext. 6914  
Fax: 708-460-2897  
Email: info@panduit.com  
Internet: http://www.panduit.com

For pricing and further information  
contact your local authorized  
PANDUIT Distributor or Sales Office

PANDUIT CANADA  
Div. of PANDUIT CORP.  
Markham, Ontario  
Phone: 800-387-9689

EUROPEAN HEADQUARTERS  
PANDUIT EUROPE LTD.  
London, UK  
Phone: 181-601-7200

ASIAN HEADQUARTERS  
PANDUIT SINGAPORE PTE. LTD.  
Republic of Singapore  
Phone: 861-3122

LATIN AMERICA  
PANDUIT LATIN AMERICAN SALES  
Florida, USA  
Phone: 954-677-2711

WORLDWIDE SUBSIDIARIES AND SALES OFFICES

SA117N237-LP

Printed in U.S.A.